

TRAILMAX[®]

Quality Trailers From
Gem State Manufacturing, Inc.

POWER RAMP TRAILERS "Setting the Industry Standard"

Maximum performance
Maximum reliability
Maximum return on investment



**TRAILMAX
QUALITY,
BACKED BY A
5-YEAR
STRUCTURAL
WARRANTY**



- High Tensile Fabricated 4-beam Construction to Minimize Excess Frame Flex and Provide a More Safe and Stable Load
- Tubular Crossmembers for Optimum Support of Concentrated Loads
- DOT Approved Sealed Beam, Rubber Isolated LED Lighting; Wiring Routed Through Tubular Construction to Protect from the Environment
- Shot Blasted Followed by a Phosphate Wash and Seal provides Clean Base of Paint Adhesion. Epoxy Primer and an Enamel Top coat for a Durable Finish
- Hydraulics to transition ramp to an 8° load angle (standard off self contained power unit – also available to run off wet kit)
- Available in various configurations including
 - Fifthwheel or tag configuration
 - Length configuration
 - Tandem or triple axle configuration
 - Various capacities available
- Various options available including
 - Wet kit in lieu of self contained power unit
 - D-rings or belt winches to specification
 - Outriggers
 - Hubometer
 - Custom paint & detail



"For the Long Haul"

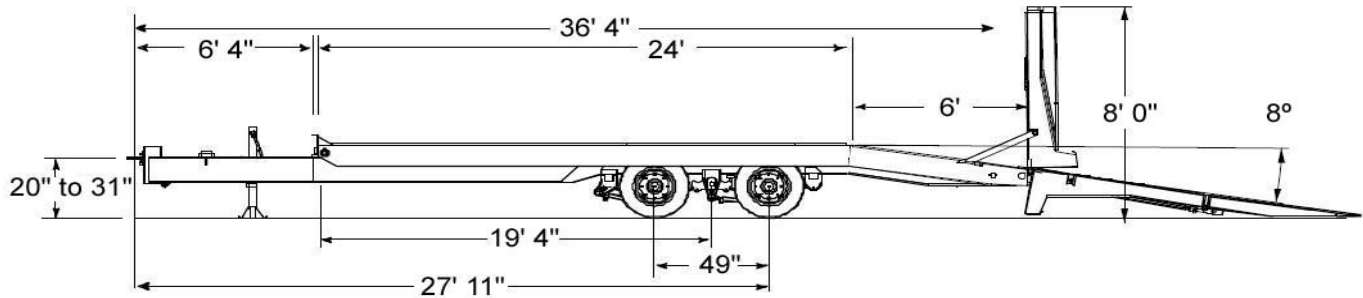

DECK WIDTH - 102"

Capacity (Distributed)	40,000 lbs.
Base Trailer Weight	10,200 lbs.
Frame Construction	Tubular subframe with high tensile perimeter rails
Crossmembers	4" x 2" x 1/8" Tube - ASTM A500B on 16" centers
Hitch	Drawbar eye, 30,000 lb. capacity adjustable
Loaded Deck Height	34"
Load Angle	8 degree
Deck Width	102"
Landing Gear	2 speed 35,000 lb. capacity, 50,000 lb. static capacity
Safety Chains	2 each 3/8" x 36" Grade 70 high test cadmium plated with slip hooks and safety latches
Load Securement	2-way Chain Slot/Stake Pocket design
Hydraulic System	Self contained electric/hydraulic
Tool Compartment	In tongue with lockable lid
Axles	2 each 23,000 lb. capacity, 5 in. round 3/8" wall thickness, 71-1/2" track and 40" spring centers
Hubs	Oil bath type with Unimount Hub and drum, 8 on 275mm bolt circle
Brakes	12-1/4" x 7-1/2" s-cam full air brakes with maxi spring brakes on both axles, automatic slack adjusters, equipped with 2S 1M anti-lock braking system
Drums	Steel Outboard type
Suspension	Hutch H-9700 tandem with axle alignment capability
Wheels	17.5" x 6.75" Uni-mount 8 on 275mm bolt circle
Tires	215/75R 17.5 radial load range H
Finish Preparation	5 stage pre-treatment
Base Coating	DuPont two-component epoxy primer sealer
Finish Coating	DuPont two-component urethane enamel top coat
Electrical	Trucklite modular system with rubber isolated, sealed beam LED lighting, protected in tube construction
Decking	2" rough surface No. 1 grade Fir with fasteners at all crossmembers
Various Options	Spare Tire, Spare Tire Carrier, Rubber Decking, Oak Decking, Traction Devices, D-rings, Belt Winches, 48" Underbody Toolbox, Custom Paint and Detail, and more

Specifications are subject to change without notice

Quality Trailers From Gem State Manufacturing, Inc.

P.O. Box 987 ~ Caldwell ~ Idaho ~ 83606 ~ 1-800-447-0213 ~ 208-455-7551 ~ Fax: 208-455-7554

www.trailmax.com